

NOTE: WALL STRUCTURE MAY VARY

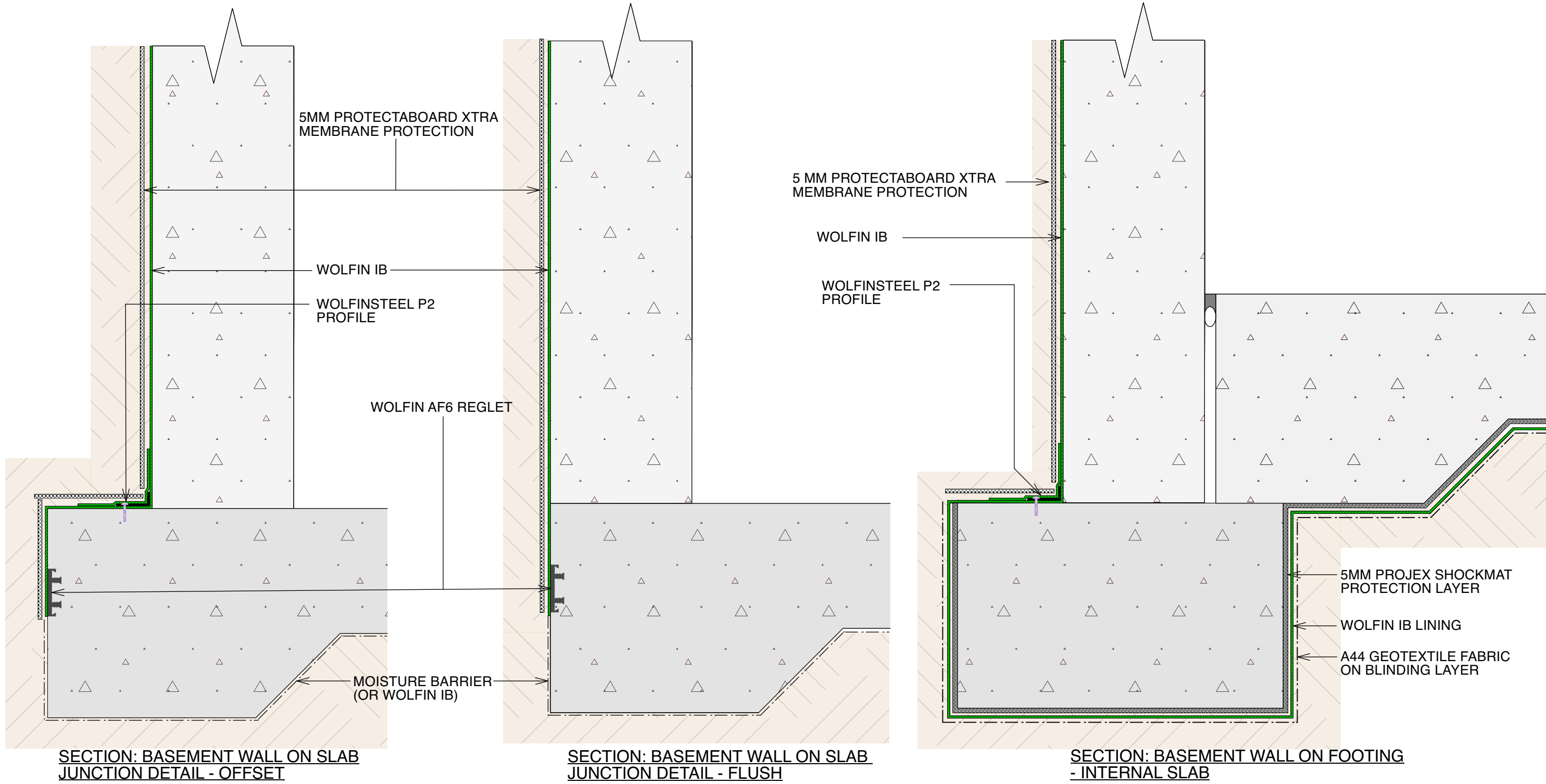

SECTION: BASEMENT WALL ON SLAB JUNCTION DETAIL - OFFSET

SECTION: BASEMENT WALL ON SLAB JUNCTION DETAIL - FLUSH

SECTION: BASEMENT WALL ON FOOTING - INTERNAL SLAB

- # All FIXINGS FOR WOLFINSTEEL PROFILES AT 150 CENTRES
- # WOLFIN MEMBRANE AND WOLFINSTEEL THICKNESS EXAGGERATED IN DRAWINGS FOR CLARITY
- # REQUIRES ADEQUATE FALLS TO DRAINAGE NOT SHOWN

The designs and details shown herein are copyright and may not be used for any purpose other than Wolfin detailing without the written permission of Wolfin Membranes Australia Pty Ltd

WOLFIN MEMBRANES AUSTRALIA - CONCEPT DRAWING



BASEMENT TANKING BASE OF WALL
WOLFIN WATERPROOFING SECTION

SCALE: 1:5 AT A3

DATE: 03/25

DRAWN BY: JT

DWG. No: WSD T2